

1

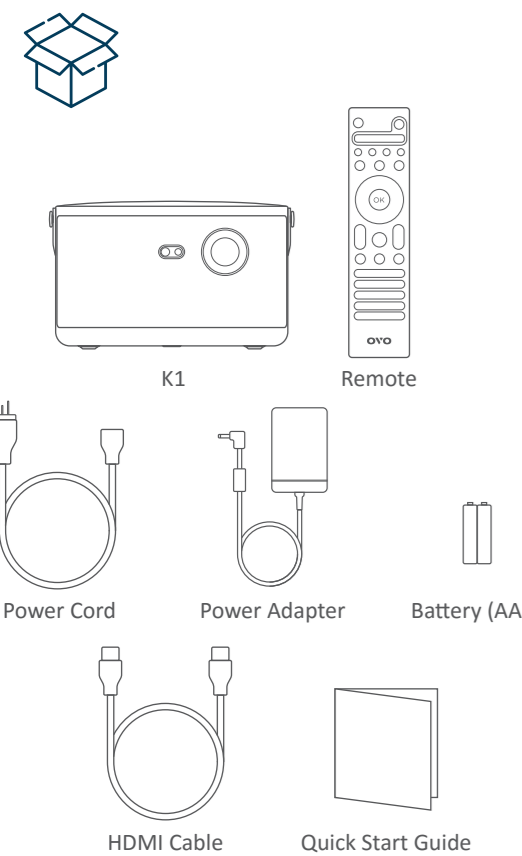

2

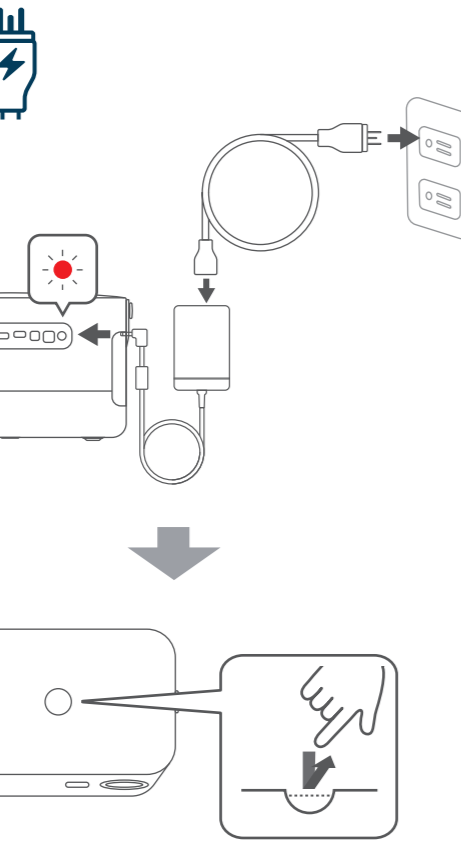

3

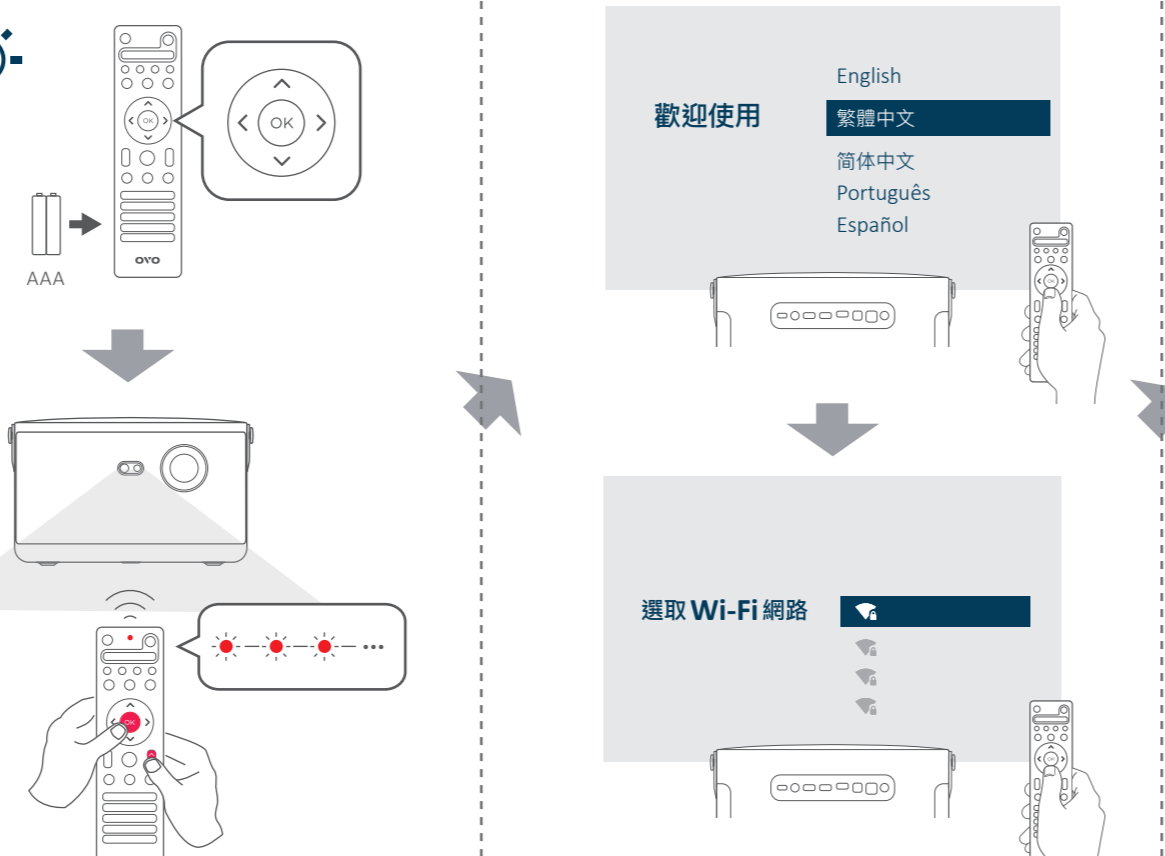

4

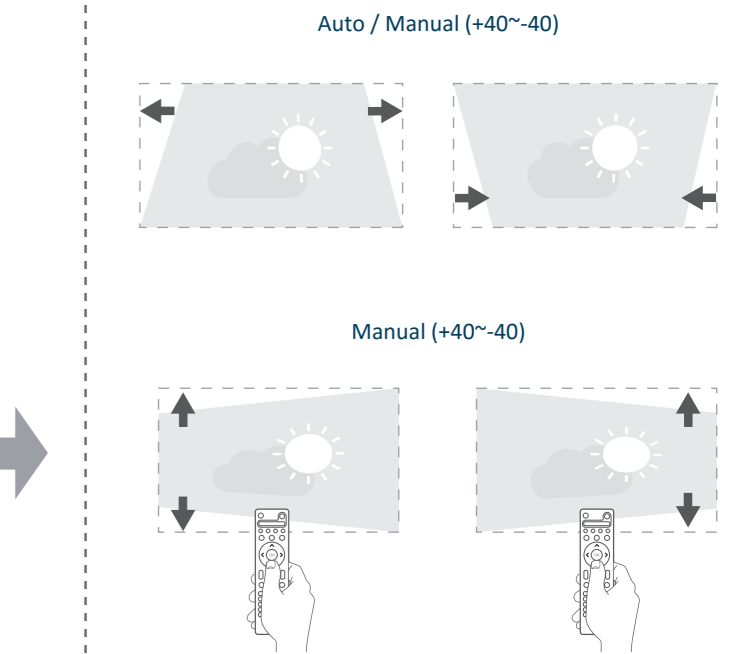
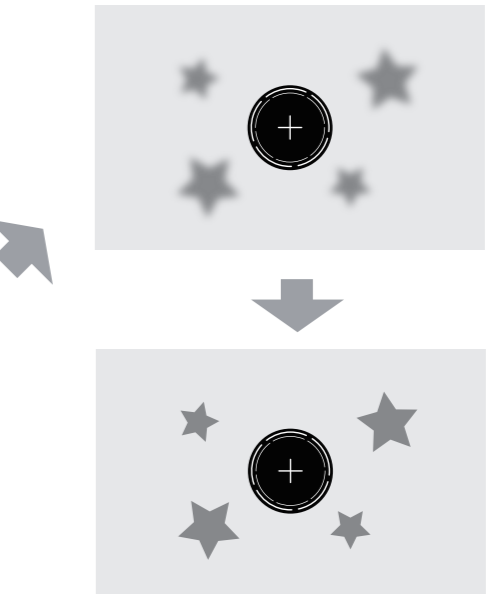
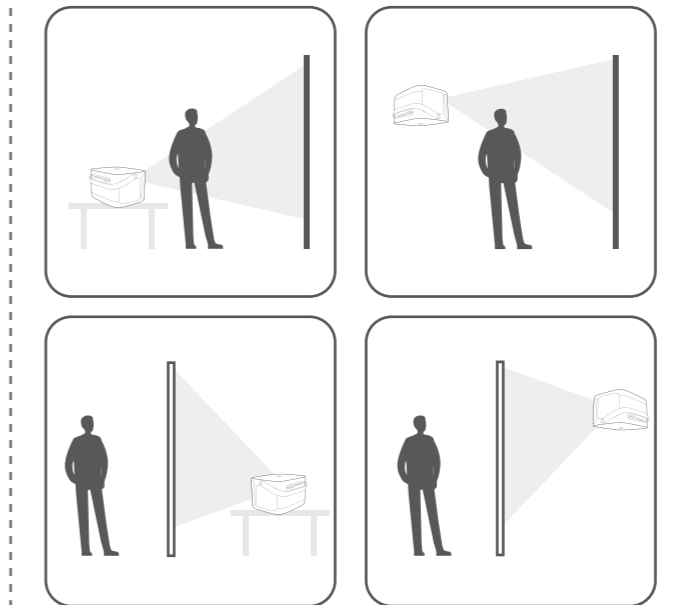
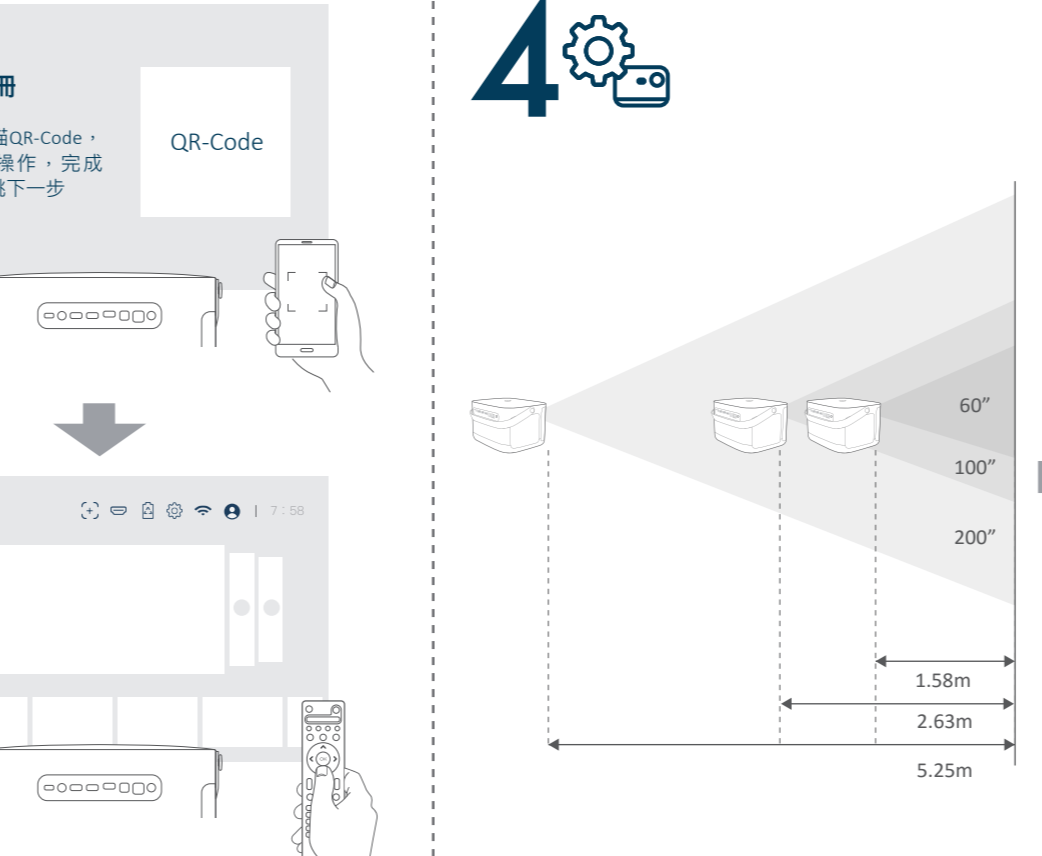

5

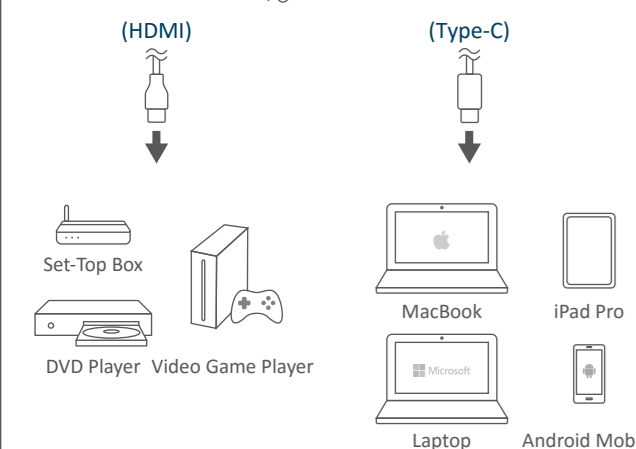
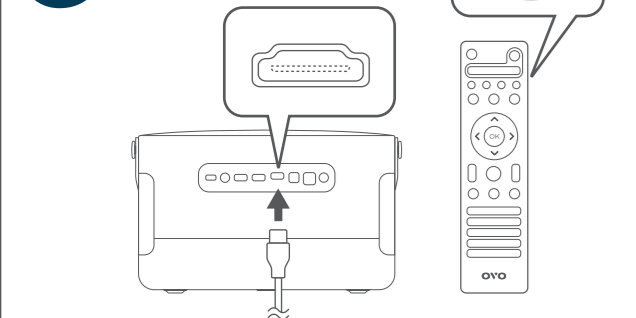

6

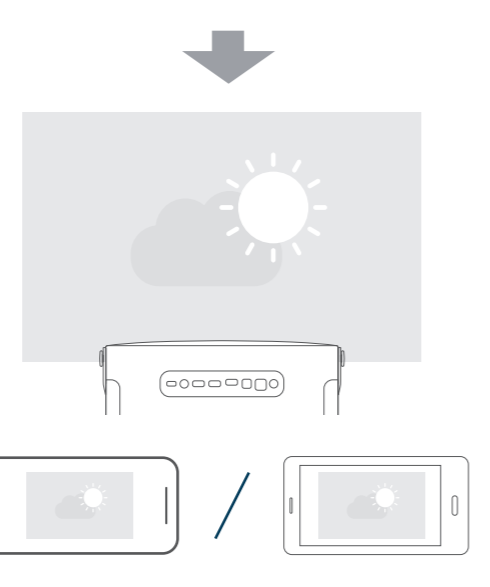
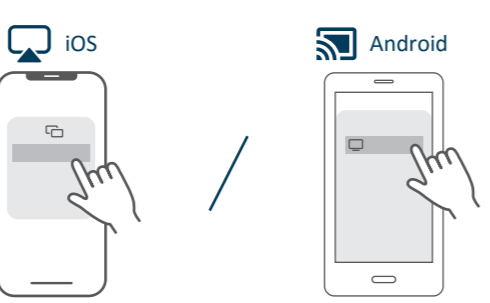
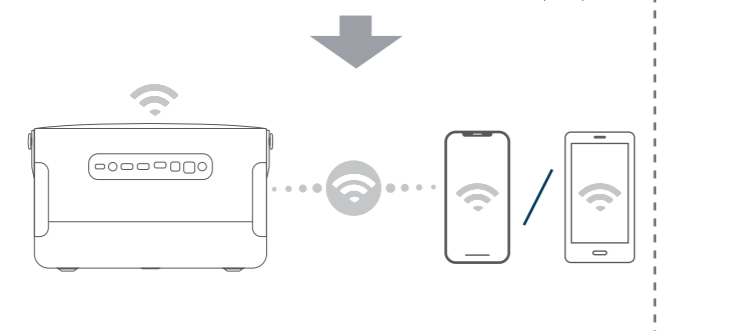
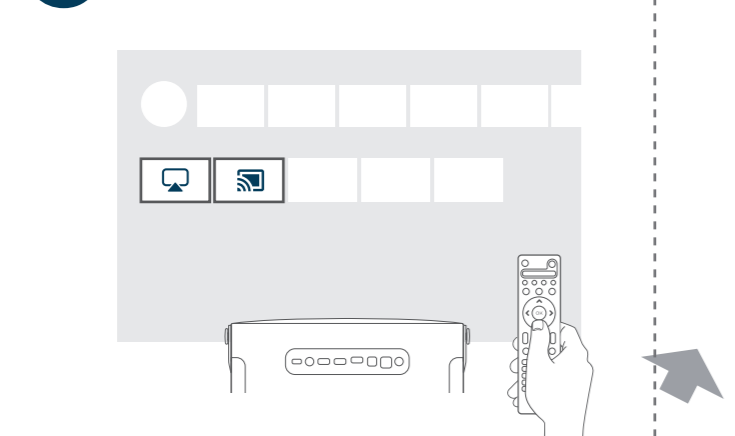

7

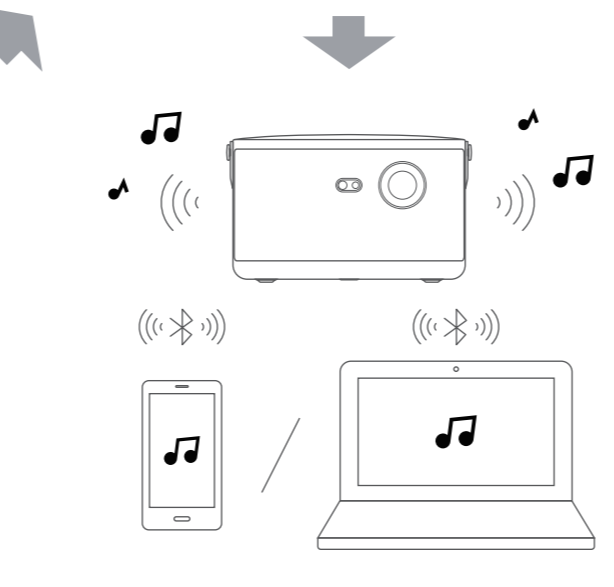
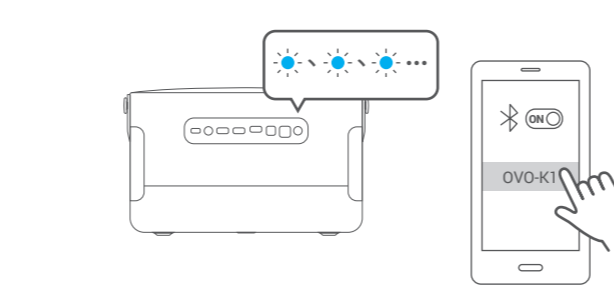
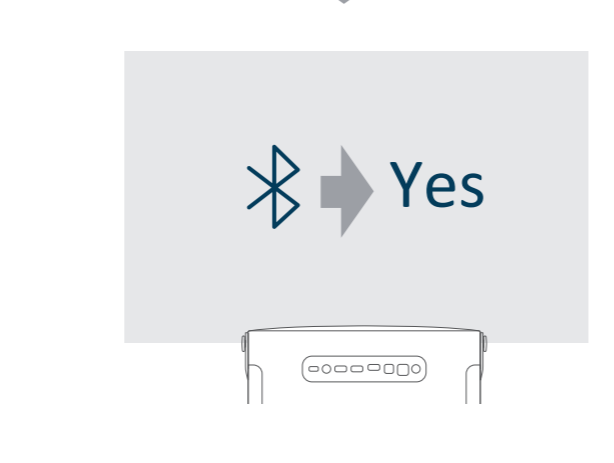

8

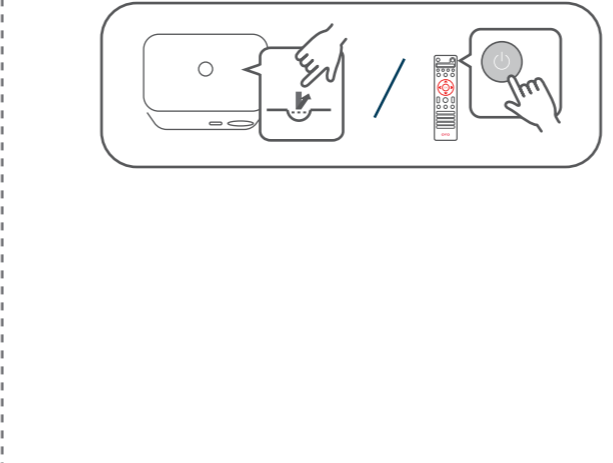
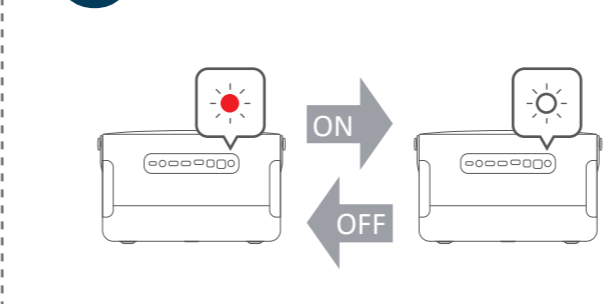

| | |
|-------|---|
| 顯示技術 | TI DLP |
| 亮度 | 3500 LED Lumens |
| 真實解析度 | 真實 1080P (1920x1080) ; 解碼 4K (3840x2160) 60P HDR |
| 投射比 | 1.2 : 1 |
| 對焦模式 | 自動對焦 |
| 梯形校正 | 垂直自動/手動校正±40度、 水平手動校正±40度 |
| 喇叭 | 5W*2 |

您可以透過以下管道獲得協助，我們將竭誠為您服務

Service: ovotv.com/support
Email: feedback@ovotv.com



- *開機後不直視光源。不遮蔽進出風口，並保持50公分以上的間距。避免曝露於陽光和熱源中。禁止掉落，小心安放。請勿自行拆解或維修，若有問題請洽客服中心。
- *Do not look straight at the projector lens during operation. Do not block the device ventilation and allow at least 50cm clearance around the projector. Avoid exposing the projector to direct sunlight or heat. Do not drop or bump the projector. Do not disassemble or repair by yourself. If there is any problem, please contact customer support.

設備名稱：OVO 無框電視 (WIFI+BT)，型號：OVO-K1
Declaration of the Presence Condition of the Restricted Substances Marking

| 單元 Unit | 限用物質及其化學符號 Restricted substances and its chemical symbols | | | | | |
|------------|--|------------------|------------------|--|---|--|
| | 鉛Lead (Pb) | 汞Mercury (Hg) | 鎘Cadmium (Cd) | 六價鉻 Hexavalent chromium (Cr ^{VI}) | 多溴聯苯 Polybrominated diphenyl (PBB) | 多溴二苯醚 Polybrominated diphenyl ethers (PBDE) |
| 外殼 | ○ | ○ | ○ | ○ | ○ | ○ |
| 鏡頭 | ○ | ○ | ○ | ○ | ○ | ○ |
| 電路板 | ○ | ○ | ○ | ○ | ○ | ○ |
| 風扇 | ○ | ○ | ○ | ○ | ○ | ○ |
| 電源供應器 | ○ | ○ | ○ | ○ | ○ | ○ |

備註1: "超出0.1 wt %" 及 "超出0.01 wt %" 係指限用物質之百分比含量超出百分比含量基準值。
Note 1: "Exceeding 0.1 wt %" and "exceeding 0.01 wt %" indicate that the percentage content of the restricted substance exceeds the reference percentage value of presence condition.

備註2: "○" 係指該項限用物質之百分比含量未超出百分比含量基準值。
Note 2: "○" indicates that the percentage content of the restricted substance does not exceed the percentage of reference value of presence.

備註3: "-" 係指該項限用物質為排除項目。
Note 3: The "-" indicates that the restricted substance corresponds to the exemption.

- [警語] 根據低功率電波輻射性電機管理辦法：
- *第十二條 經型式認證合格之低功率射頻電機，非經許可，公司、商號或使用者均不得擅自變更頻率、加大功率或變更原設計之特性及功能。
 - *第十四條 低功率射頻電機之使用不得影響飛航安全及干擾合法通信；經發現有干擾現象時，應立即停用，並改善至無干擾時方得繼續使用。前項合法通信，指依電信法規定作業之無線電通信。低功率射頻電機須忍受合法通信或工業、科學及醫療用電波輻射性電機設備之干擾。
 - *根據低功率射頻電機技術規範：4.7.9.1 應避免影響附近雷達系統之操作。4.7.9.2 高增益指向性天線只得應用於固定式點對點系統。



OVO 無框電視 K1 智慧投影機 (WIFI+BT) 快速安裝指南 Quick Start Guide

展雋創意股份有限公司
Ovomedia Creatice Inc.
www.ovotv.com